

SEIKO CHROMATIC TUNER ST01/ST02

INSTRUCTION MANUAL

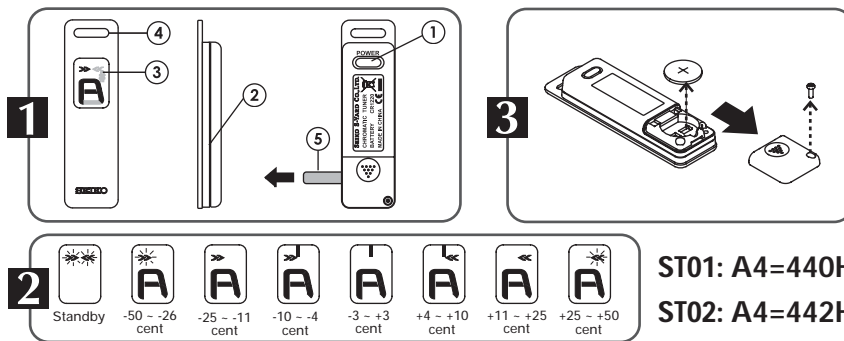

ST01: A4=440Hz

ST02: A4=442Hz

PART NAMES & HOW TO USE 1

- ① **Power switch**
Press to turn ON/OFF power.
- ② **Built-in microphone**
Input sound of instrument you wish to tune.
* For accurate tuning, tune instrument in a quiet environment while placing it close to Tuner.
- ③ **Tuning indicator**
Name of note input and deviation in cent are indicated using LCD display and LED light. (See 2.)
- ④ **Strap hole**
Use it to attach key ring included or strap of your choice.
- ⑤ **Insulator sheet**
When using Tuner for the first time, pull it out gently in direction of arrow.

AUTO POWER-OFF FUNCTION

If Tuner is left untouched without inputting sound, it will turn OFF automatically in approximately 2 minutes. To turn it ON again, press power switch.

BATTERY CHANGE

- Ensure that Tuner is turned OFF. Remove screw fixing battery cover on rear of Tuner, and slide it in direction of arrow to remove it. (See 3.)
- Insert battery with its (+) side up.
- Be sure to use a specified lithium battery (CR1220) only.

* The battery included with your Tuner is a monitor battery, and may not last as long as specified.

* When battery nears its end, Tuner may not work properly. Replace battery with a new one immediately.

* When disposing of old battery, observe regulations of authorities concerned.