

SII POS Printer RP Series

 **RP-F10**
SERIES

Built-in COLOR LCD **DSP-A01**

Flexible Layout

2-way: Paper top-exit and front-exit (IPx1)

High Speed & High Quality

Max 250mm/sec

Safety Design

Easy recovery from paper jam

Eco Friendly

Compliant with the International Energy Star Program

Paper Saving Mode

Convenient software tools

Driver, SDK, Web application, etc. (Windows, iOS, Android) □

RP-F10 SERIES

- Printing speed: Max 250mm/s
- 4.3-inch color LCD (option)
LCD can be connected to RP-F10 via USB and powered by USB
- Easy pairing with a Bluetooth device using NFC (Bluetooth Model)

Easy



2 Way

Dual use receipt printer and kitchen printer Compatible with one model.

*Drip-proof properties (equivalent to IEC60529 IPX1)

when using front paper exit
Compatible with 2 inch/3 inch paper.

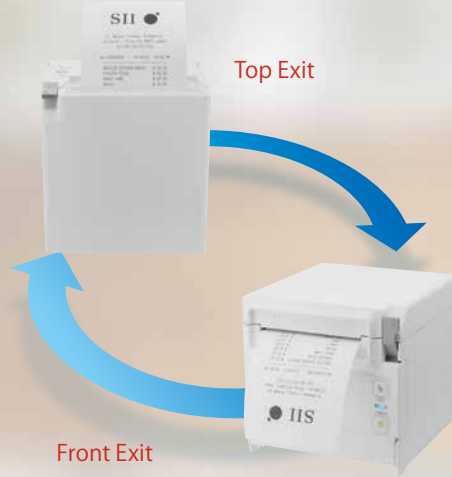

4.3 inch TFT



COLOR Display



RP-F10 communicates with the display (DSP-A01*) via USB-A port.

In addition, DSP-A01 can be attached to the back of the RP-F10, which makes minimal and stylish layout at cashier.

*option



USB Type-C PD model (RP-F10-K/W27J1-5)

USB Type-C connection allows you to connect USB PD compatible Android/iOS(Lightning port)/Windows devices*₁ with stable wired communication and high-speed charging.

*₁ Even with USB PD compatible products, some Android devices may not be able to perform USB communication.



USB Type-C/PD

Compact

Ultra compact

W127x
D127x
H127mm

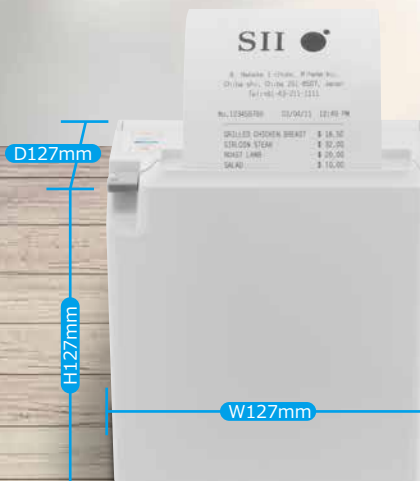

RP-F10(White)



RP-F10(Black)

Display

DSP-A01

For various purposes

QR payment
Couponing Signage
(displaying slide shows)
etc.

Various placement

- On RP-F10
- Stand-alone
- Wall-mounted

Error Indication

When connected to RP-F10, error details and countermeasures can be displayed.



Slideshow Setting Utility

This is utility software for slideshow setting.
End users can edit slides such as advertisements with simple operations. (iOS/Android/Windows)



DSP-A01 Specification

LCD	Method	4.3 inch TFT Color LCD
	Number of pixels/display area	W480×H272 [pixels] / W95.04×H53.856 [mm]
Character	Character configuration(H×W)	24×12, 24×24, 16×8, 16×16 [pixels]
	Number of characters	ANK : 320 characters (40 characters x 8 lines) Kanji : 160 characters (20 characters x 8 lines)
	Character type	Codepage (18 Pages), Optional font (max. 255 × 255 pixel), JIS 1 & 2 Level Kanji, Special characters
Character decoration	Vertical double (×2, ×4), Horizontal double (×2, ×4), Bold, Underlin	
Barcode	1D	UPC-A/E, JAN (EAN) 8 /13, ITF, CODABAR, Code39, Code128
	2D	QR code (Version 1 to 22, Cell size 1 to 16 pixel)
Image		JPEG, PNG
Power supply		DC 4.75 V to 5.25 V (Activated with USB bus power)
Communication interface		USB 2.0 Full speed, micro B connector
Installation method		Mounted on printer (RP-F10), Stand-alone, Fixing screw (wall mount)



DSP-A01 (White)



DSP-A01 (Black)

Specification

Model		RP-F10
Printing	Method	Thermal line dot printing
	Resolution (dpi)	203(8dots/mm)
	Paper width (mm)	58 ⁺⁰ ₋₁ / 80 ⁺⁰ ₋₁
	Printing width (mm)	54 / 72
	Speed (mm/sec) max	250
	Outside diameter of paper roll (mm) max	φ83
	Character matrix (H × W dots)	24×12、24×24、16×8、16×16
	Character size (H × W mm)	3.0×1.5、3.0×3.0、2.0×1.0、2.0×2.0
Type of Paper	Roll paper	
Character type	Codepage (14 pages), Katakana character set, User-defined character, Downloaded character, Optional font, JIS 1st and 2nd level Kanji, Special characters	
Bar code	UPC-A/E, JAN(EAN)8/13, ITF, CODABAR, Code39, Code93, Code128, QR, PDF417, MaxiCode, Data Matrix, GS1 Databar	
Input buffer	4K bytes	
Command	ESC/POS™ conformity	
Cutting	Method	Slide type
	Cutting type	Full cut / Partial cut (Leave center point)
Operating temperature (°C)	5 to 45	
Service life	Abrasion resistance (km)	150*1
	Paper cutting (cut)	1,500,000*1
Dimensions (W×D×H mm)	127.0×127.0×127.0*2	
Mass (g)	Approx. 840	
Standard	FCC, CE, VCCI	
Option	Wall mounting Kit, Buzzer, LCD (4.3inch color)	
Cash drawer	2 drivers (24V / 1A)	
Body color	2 colors: White / Black	

*1 Use recommended thermal papers. *2 Excluding protrusion.

Communication interface

Model	Interface	Part Number(White)	Part Number(Black)
USB Model	USB+USB host*	RP-F10-W27J1-2	RP-F10-K27J1-2
Ethernet Model	Ethernet+USB host*	RP-F10-W27J1-3	RP-F10-K27J1-3
Bluetooth Model	Bluetooth(NFC)+USB host*	RP-F10-W27J1-4	RP-F10-K27J1-4
USB Type-C PD Model	Bluetooth(NFC)+USB Type-C/PD+USB host*	RP-F10-W27J1-5	RP-F10-K27J1-5

*Can be used to connect with the display (DSP-A01).

Options list

Accessories	RP-F10
AC adapter	PW-G2421-W1
AC cable	It varies by country. Please contact us separately.
USB Cable	IFC-U02-2
Powered USB Cable	IFC-V01-1
Serial Cable	IFC-S02-2
Wall mount kit	WLK-B01-1
Cash Drawer	DRW-A01-W(White), DRW-A01-K(Black)
Buzzer	BZR-A01-1
Display	DSP-A01-W1 (White)
	DSP-A01-K1 (Black)

Software list

OS	Software
Windows	Printer Driver
	OPOS
	POS for .NET
Linux	CUPS
	SDK
Android	SDK
	SII URL Print Agent
	SII SDK for MAUI
iOS	SDK
	SII URL Print Agent
	SII SDK for MAUI

*Support status varies depending on the interface.

- ⚠ Windows® is the registered trademark of Microsoft Corporation (USA).
- ⚠ Bluetooth® is a registered trademark of Bluetooth SIG.
- ⚠ Wi-Fi® is a registered trademark of Wi-Fi Alliance.
- ⚠ iPad, iPhone, iPod are trademarks of Apple Inc., registered in the U.S. and other countries.
- ⚠ iOS is a trademark or registered trademark of Cisco in the U.S. and other countries and is used under license.
- ⚠ Android™ is a trademark of Google Inc.
- ⚠ Linux® is a registered trademark of Linus Torvalds in the United States and / or other countries.
- ⚠ QR Code is a registered trademark of DENSO WAVE Inc.
- ⚠ ESC/POS™: Registered trademark of SEIKO EPSON CORP.
- ⚠ Other company names and product names are trademarks or registered trademarks of their respective companies.

Specifications are subject to change without notice.



Seiko Instruments Inc.

Print System Division
563, Takatsukashinden, Matsudo-shi, Chiba 270-2222, Japan
Telephone:+81-47-709-0925 Facsimile:+81-47-709-1793
<https://www.sii.co.jp/sps/eg/>

Seiko Instruments U.S.A., Inc.

21221 S. Western Ave., Suite 250, Torrance, CA 90501, USA.
Telephone:+1-310-517-7778 Facsimile:+1-310-517-8154
<https://sii-thermalprinters.com/>

Seiko Instruments GmbH

Siemensstrasse 9 D-63263 Neu-Isenburg, Germany
Telephone:+49-6102-297-0 Facsimile:+49-6102-297-50100
E-mail : info@seiko-instruments.de
<https://www.seiko-instruments.de>

Seiko Instruments Trading (H.K.) Ltd.

7 / F, Ying Industrial Building, 802 Lai Chi Kok Road, Kowloon, Hong Kong
Telephone:+852-2494-5160 Facsimile:+852-2424-0901

Seiko Instruments Taiwan Inc.

2F., No. 143, Changchun Rd.,
Taipei, Taiwan R.O.C.
Telephone:+886-2-2563-5001 Facsimile:+886-2-2563-5580
<http://www.sii.com.tw/en/index.html>