

# INSTRUCTION MANUAL

Thank you for purchasing the SEIKO QUARTZ e-PENDULUM METRONOME EPM5000. Carefully read this instruction manual before using your EPM5000, as proper use is important to ensure the life of the product. Store this instruction manual in a place that is readily accessible and refer to it regularly.

## PRECAUTIONS

The following precautions are important in ensuring the safe and proper use of the product, preventing injury to yourself and others, and preventing damage to your belongings.

Please adhere to the following warnings.

- Do not disassemble, attempt to repair, or tamper with the metronome or battery.
- Do not handle the metronome with wet hands.
- Do not use or store the metronome in places where it may become wet such as in bathrooms, near sinks, or outdoors.
- Do not expose the batteries to fire.
- Use only the battery-type specified for the metronome.
- Do not insert pins or other foreign objects into the metronome.
- In the event that such an object gets trapped in the device, cease use of the device and contact the store of purchase or a professional for assistance.
- Do not place the metronome on unstable surfaces.
- Do not intentionally throw or drop the metronome.
- Do not use or store the metronome in places where it may be exposed to extremely high temperatures such as near heaters, on devices that generate heat, in direct sunlight, or in vehicles.
- Do not use or store the metronome in places where it may be exposed to extremely high levels of humidity.
- Keep the metronome out of the reach of small children.
- Keep removed batteries and the battery lid out of the reach of small children. In the event that a child swallows these parts, contact a physician immediately.
- Do not apply excessive force to the buttons or body of the metronome.
- Do not mix old and new batteries or batteries of different types.
- Do not let leaked battery fluid come in contact with your skin.
- Do not use or store the metronome in dusty places or places prone to vibration.
- Do not use thinner or alcohol to clean the metronome.
- Do not place the main unit near your face or within the reach of small children.
- Do not touch the e-PENDULUM while it is in motion.
- Replace all (four) batteries of the main unit at the same time. When installing new batteries, check that the (+) and (-) terminals are oriented correctly.
- Remove the batteries when depleted or when not using the metronome for a long period of time.

Insert the batteries as explained below before using your EPM5000.

Main Unit: See the instructions in the [BATTERY REPLACEMENT] section and insert the included batteries.

Remote: Remove the battery pull tab, as shown in the diagram to the right, before use.

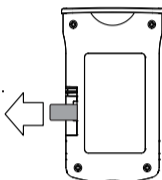

The batteries included with the tuner are for functionality testing and their life may be shorter than expected.

## NAMES OF PARTS

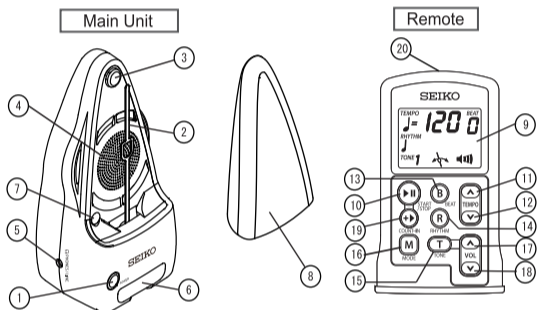

### [MAIN UNIT]

#### ① POWER button

Press the POWER button to turn the metronome on and off.

Input using the remote and battery life are indicated by the color and blinking status of the POWER button (see below for details).

Power on (operating mode): Solid blue light

Input using the remote: Blinking blue light

e-PENDULUM error: Solid red light

Low batteries: Flashing red light

In the case of an e-PENDULUM error, remove the obstruction and then press the POWER button. The metronome will be reset to operation mode and the POWER button will show as blue.

#### ② e-PENDULUM

Oscillates in time with the set tempo.

#### ③ e-PENDULUM tab

Fixes the e-PENDULUM in place when not in use. The tab also serves to hold the cover in place.

#### ④ Speaker

Produces a clicking sound in time with the tempo.

#### ⑤ Earphone jack

Tempo sounds can be played through an earphone (sold separately). The metronome may also be connected to an amplifier or other external speaker. The internal speaker, located in the main unit, is automatically disabled when the earphone jack is in use.

※ Check volume settings before using an earphone or external speaker.

#### ⑥ Remote

Used to operate the main unit.

#### ⑦ Receiver

Receives input from the remote.

#### ⑧ Cover

Used to protect the e-PENDULUM when not in use.

### [REMOTE]

#### ⑨ LCD screen

Configurable options are displayed on the LCD screen.

#### ⑩ START/STOP button

Start or stop the operation of the main unit.

#### ⑪ TEMPO up button / ⑫ TEMPO down button

Used to set the tempo. 39 steps between 40 to 208 beats/min are available. Hold down a button to scan quickly through the steps.

#### ⑬ BEAT button

Used to set the number of beats (0 or 2 to 6 beats).

#### ⑭ RHYTHM button

Used to select the rhythm (8 types available).

#### ⑮ TONE (sound) button

Used to select the tempo sound (3 types available).

#### ⑯ MODE button

Used to switch between the following three operational modes.

Normal Mode	Sound off mode	e-PENDULUM off mode
e-PENDULUM: Swing Sound: On	e-PENDULUM: Swing Sound: Off	e-PENDULUM: No swing Sound: On

#### ⑰ VOLUME up button / ⑱ VOLUME down button

Used to set the volume to one of six levels (level 0 to level 5).

#### ⑲ COUNT-IN button

Press to start the metronome with a lead-in. If pressed during operation, the metronome will restart with a lead-in.

#### ⑳ Transmitter

The part of the remote from which signals are transmitted to the main unit.

## HOW TO USE

### PRECAUTIONS

- Be sure to remove the cover and release the e-PENDULUM from the e-PENDULUM tab prior to using. If the POWER button on the main unit is pressed while the cover is on or the e-PENDULUM is still held in place by the e-PENDULUM tab, the main unit POWER button will turn red and all movement will stop. Leaving the EPM5000 in this state may result in damage to the device.
- All operations except turning the power of the device on and off are performed using the remote.

The approximate range of the remote is as shown below. Use the remote from a location close to the main unit and point the transmitter of the remote toward the receiver of the main unit.

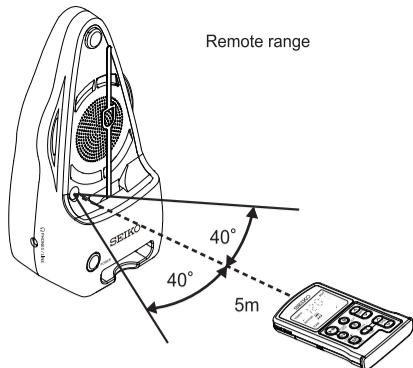

### (1) Preparing the metronome for use

- Remove the cover from the main unit by holding the bottom of the cover as shown in FIG. 1 and pulling it forward.
- Pull the remote out of the main unit by hooking your finger in the notch as shown in FIG. 2 and pulling the remote forward.
- Release the tip of the e-PENDULUM from the e-PENDULUM tab by pressing the top of the e-PENDULUM down and sliding it out from under the tab.

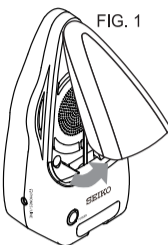

FIG. 1

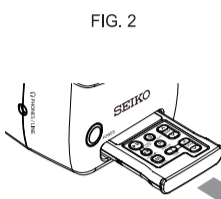

FIG. 2

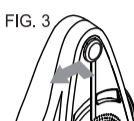

FIG. 3

### (2) Press the POWER button on the main unit.

- Using the remote, set your desired tempo, beats, rhythm, tone, volume, and mode.

Your settings will be shown on the LCD screen as depicted below.



### (4) The metronome can be started in the following ways.

- Press the START/STOP to start the metronome immediately.
- Press the COUNT-IN button to start the metronome with a lead-in. The lead-in consists of the number of beats set.
- The tempo, beats, rhythm, tone, volume, and mode can each be changed while the metronome is in operation. The POWER button of the main unit will blink blue when the changes input using the remote are successfully received.
- Press the START/STOP button again to stop the metronome.
- When finished using, turn the main unit power off, fix the e-PENDULUM under the e-PENDULUM tab, and return the remote to its slot in the main unit. Then, replace the cover and store the device.

Auto power-off feature: The main unit power will automatically turn off after about 30 minutes when the remote has not been used and the metronome is not in operation even though the main unit power is turned on.

## CAUTION

- Metronomes are precision instruments. Be careful not to drop your metronome or expose it to impacts.
- Turn the power off and replace the cover before moving/relocating the main unit.
- Do not touch or try to stop the movement of the e-PENDULUM. Moreover, unless necessary, do not touch or try to move the e-PENDULUM when not in use. Doing so may result in damage to your metronome.
- In the case that the remote battery becomes depleted or the remote ceases to function properly while the metronome is in use, press the main unit POWER button to stop the metronome.
- The POWER button will turn solid red and the metronome will stop in the event of a problem with e-PENDULUM movement. In such a case, check that the e-PENDULUM is not stuck under the e-PENDULUM tab and then press the POWER button to reset the device. If the POWER button color changes to blue the problem is resolved.
- For all other problems that occur during operation, power cycle the device by removing and reinserting the batteries of the main unit and the remote.
- In cases where the POWER button continues to show an error or where the problem cannot be resolved, contact the store of purchase or a professional for assistance.
- Take care when multiple metronomes are placed in close proximity to each other, as one remote may operate all of them simultaneously.

## BATTERY REPLACEMENT

The POWER button will blink red when the batteries need to be replaced. The LCD screen will dim and input will not be transmitted successfully when the remote battery needs to be replaced. Your metronome will cease to function properly when battery strength is low. Replace the batteries as soon as possible.

### ○ Replacing the main unit batteries

Turn the power off. Locate the battery lid on the back side of the main unit. Remove the lid as shown in FIG. 4 and remove the four depleted batteries. Install four new batteries in the battery holder, making sure that the batteries are aligned with the polarity markings. Replace the battery lid. After replacing the batteries, turn the main unit on and confirm that the metronome functions normally.

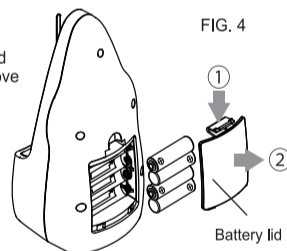

FIG. 4

※ While rechargeable batteries (AA Ni-MH batteries) can be used in the main unit, alkaline batteries are recommended.

### ○ Replacing the main unit batteries

Locate the battery tray on the back side of the remote and remove it as shown in FIG. 5. Remove the depleted battery. The remote is reset to factory settings when the battery is replaced (default settings: tempo: 120; beats: 0; rhythm: J tone: 1; mode: regular mode; volume level: 3).

※ Be sure that the (+) and (-) terminals of the batteries are oriented correctly.

※ Follow all local ordinances and regulations when disposing of the depleted battery.

※ Store removed batteries and battery covers out of the reach of small children. In the event that a child swallows these parts, contact a physician immediately.

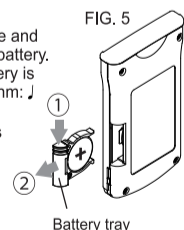

FIG. 5

## SPECIFICATIONS

- Tempo range and accuracy: 40 ~ 208 beats/min (39 steps), ±0.2%
- Beat range: 0, 2 ~ 6
- Rhythm patterns:
- Tempo tone/sound: 3 types
- Volume control: 6 levels (0 ~ 5)
- Auto power-off: approx. 30 minutes (main unit only; when the remote has not been used and the metronome is not in operation)
- Earphone jack: Φ 3.5 mm, stereo output
- Power supply: [Main unit] Four (4) AA batteries (alkaline batteries recommended) (AA Ni-MH batteries may also be used) [Remote] Lithium battery (CR2032×1)
- Battery life: [Main unit] Approx. 10 hours (alkaline batteries, continuous use at a 120 tempo, 2 beats, rhythm J, tone 1, normal mode, and volume level 3) [Remote] 6 months or longer (depending on usage)
- Operating temperature range: 5°C ~ 40°C
- Overall dimensions and weight: [Main unit] 101 (W) × 218 (H) × 98 (D) mm, approx. 550 g (including batteries) [Remote] 55 (W) × 90 (H) × 13 (D) mm, approx. 50 g (including battery)
- Accessories: [Main unit] AA alkaline battery × 4 (for functionality testing) [Remote] Lithium battery CR2032 × 1 (for functionality testing) Instruction manual