

**INSTRUCTION MANUAL**

Thank you for purchasing the SEIKO ERHU TUNER STX5A. Carefully read this instruction manual before using your STX5A as proper use is important to ensure the life of the product.  
Store this instruction manual in a place that is readily accessible and refer to it regularly.





**FOR SAFE OPERATION**

The following warnings and cautions are important in ensuring safe and proper use of the product, preventing injury to yourself and others, and preventing damage to your belongings.

— Please adhere to the following warnings. —

**WARNING**



Disregard of these warnings may result in injury or death.

-  Do not disassemble, attempt to repair, or tamper with the tuner or battery.
-  Do not handle the tuner with wet hands.
-  Do not use or store the tuner in places where it may become wet such as in bathrooms, near sinks, or outdoors.
-  Do not expose the battery to fire.
- Use only the battery specified for the tuner.
- Do not insert pins or other foreign objects into the tuner.
- Do not place the tuner on unstable surfaces.
- Do not intentionally throw or drop the tuner.
- Do not use or store the tuner in places where it may be exposed to extremely high temperatures such as near heaters, on devices that generate heat, in direct sunlight, or in vehicles.
- Do not use or store the tuner in places where it may be exposed to extremely high levels of humidity.

-  Do not let small children play with the tuner.
- Keep removed battery and the battery lid out of the reach of small children. In the event that a child swallows these parts, contact a physician immediately.

**CAUTION**

Disregard of these cautions may result in injury or physical damage.

-  Do not exceed the stipulated range of movement of the clip.
- Do not apply excessive force to the buttons or body of the tuner.
- Do not let leaked battery fluid come in contact with your skin.
- Do not use or store the tuner in dusty places or places prone to vibration.
- Do not use thinner or alcohol to clean the tuner.
-  Install the battery properly, checking that the (+) and (-) terminals are oriented correctly.
- Be careful not to pinch fingers in the clip.
- Remove the clip from your instrument when not using the tuner.
- Remove the battery when it is depleted or when not using the tuner for a long period of time.

Before using the tuner for the first time, remove the battery pull tab by gently pulling the tab in the direction of the arrow shown in the drawing. The battery included with the tuner is for functionality testing and its life may be shorter than expected.

**NAMES OF PARTS**

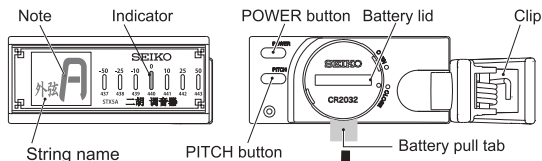

**TUNING YOUR GUITAR/BASS**

■ Attaching the Tuner  
Clip the tuner securely to your instrument and adjust the clip so that you can see the screen clearly. Make sure that adjustments made to the clip are within its stipulated range of movement (see drawing).

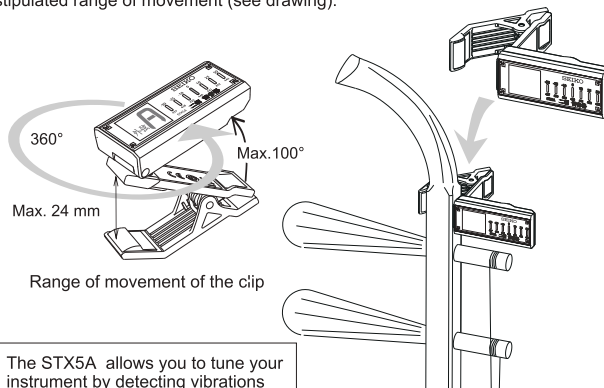

The STX5A allows you to tune your instrument by detecting vibrations generated by your instrument. If you experience difficulty tuning, clip the tuner to a different part of your instrument or adjust the orientation of the clip.

- \* Do not exceed the stipulated range of movement of the clip.
- \* Remove the clip from your instrument when not using the tuner. Leaving the tuner clipped to your instrument for a long time may result in marking or discoloration of your instrument.

■ Tuning your Instrument  
Press the POWER button to turn on your tuner. When turned on, the last A4 reference pitch that was set will flash on the indicator. Press the PITCH button to set the reference pitch according to the reference pitch meter.

• How to tune the outside string  
Adjust the string so that the note A is displayed while playing the outside string. (If the note D is displayed, the note is too flat so please adjust the string accordingly)  
While the note A is displayed, tune the Erhu so that the middle green light of the indicator lights up.

• How to tune the inside string  
Adjust the string so that the note D is displayed while plying the inside string. (If the note A is displayed, the note is too sharp so please adjust the string accordingly)  
While the note D is displayed, tune the Erhu so that the middle green light of the indicator lights up.

- \* Ambient sound or hum noise from electronic appliances may cause the tuner to behave as if in use. This is not a malfunction.
- \* After a short period of tuning or button inactivity while the tuner is turned on, the LCD screen will be dimmed incrementally. The tuner will automatically turn off after about ten minutes of inactivity. This function is provided to extend the life of the battery.

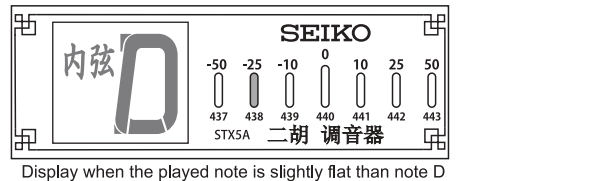
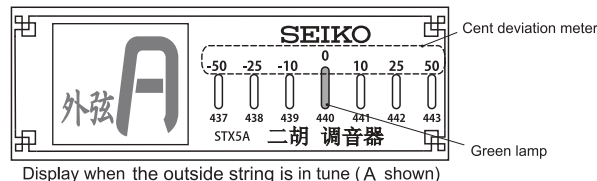
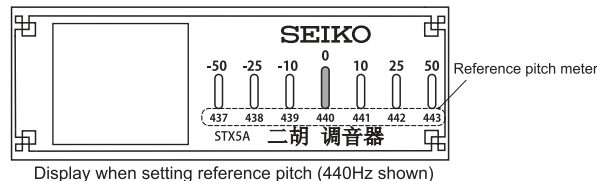

**BATTERY REPLACEMENT**

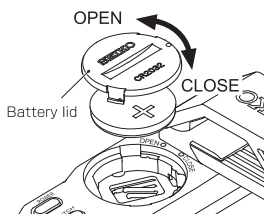

Dimming of the tuning lamps or the LCD screen occurs when the battery is depleted. In these cases, replace the battery immediately.

Press the POWER button to turn off the tuner. Turn the tuner over and rotate the clip until the battery lid is completely exposed. Use a coin, etc. to rotate the battery lid clockwise until the tab on the battery lid aligns with the OPEN position and remove the depleted battery. Install a new battery (model number:

CR2032) with the (+) side facing up. Replace the battery lid and rotate it clockwise until the tab on the battery lid aligns with the CLOSE position. After replacing the battery, confirm that the tuner functions normally. Reference pitch settings are reset to factory settings (440 Hz) when the battery is replaced.

- \* Be sure that the (+) and (-) terminals of the battery are oriented correctly.
- \* Follow all local ordinances and regulations when disposing of the depleted battery.

Keep removed battery and the battery lid out of the reach of small children. In the event that a child swallows these parts, contact a physician immediately.

**SPECIFICATIONS**

- Tuning notes : A,D
- Tuning range (accuracy) : C3~B5 (±1 cent)
- Pitch shift : A4= 437 ~ 443 Hz (1 Hz steps)
- Auto power-off : 10 min.
- Input method : Built-in vibration sensor
- Power supply : Lithium battery (CR2032×1)
- Battery life : Approx. 15 hours (at continuous A4 input)
- Overall dimensions and weight : 62 (W) × 26 (H) × 34 (D) mm (excluding protruding parts); approx. 35g (including battery)
- Opening range of the clip : 24 mm
- Accessories : Instruction manual and one (1) Lithium battery CR2032 (for functionality testing)

\* The design and specifications are subject to change without prior notice for product improvement.

Seiko Instruments Inc. <http://www.sii.co.jp/music/english/>

**FEDERAL COMMUNICATIONS COMMISSION RADIO FREQUENCY INTERFERENCE STATEMENT**

This equipment has been tested and found to comply with the limits for a Class B digital device, pursuant to Part 15 of the FCC Rules. These limits are designed to provide reasonable protection against harmful interference in a residential installation. This equipment generates, uses and can radiate radio frequency energy and, if not installed and used in accordance with the instructions, may cause harmful interference to radio communications. However, there is no guarantee that interference will not occur in a particular installation. If this equipment does cause harmful interference to radio or television reception, which can be determined by turning the equipment off and on, the user is encouraged to try to correct the interference by one or more of the following measures:



- Reorient or relocate the receiving antenna.
- Increase the separation between the equipment and receiver.
- Connect the equipment into an outlet on a circuit different from that to which the receiver is connected.
- Consult the dealer or an experienced radio/TV technician for help.

This device complies with Part 15 of the FCC Rules. Operation is subject to the following two conditions:  
(1) this device may not cause harmful interference, and  
(2) this device must accept any interference received, including interference that may cause undesired operation.  
This Class B digital apparatus complies with Canadian ICES-003.

**CALIFORNIA, USA ONLY**

This perchlorate warning applies only to primary CR (Manganese Dioxide) Lithium coin cells sold or distributed ONLY in California USA. "Perchlorate Material-special handling may apply. See www.dtsc.ca.gov/hazardouswaste/perchlorate."

**NOTICE (for EU only)**

-  This symbol means that electrical and electronic equipment, at their end-of-life, should be disposed of separately from your household waste. If you ever need to throw away an old tuner or any of its components, please ensure that it is disposed of carefully in the way designated by local authorities.
-  This symbol (Directive 2006/66/EC Annex II) indicates separate collection of waste batteries in the EU countries. Please use the return and collection systems available in your country for the disposal of the waste batteries.